



**FW2-SPLG**  
REMOTE CONTROLLED AC PLUG SOCKET  
P/N 7104700 REV. A (DZ)

## INTRODUCTION

The FW2-SPLG is a remote controlled AC plug socket for indoor use.

This FW2-SPLG is easy-to-install and can be plugged into any socket of your choice, allowing you to control any electrical appliance rated less than 3200W (heater, lamp, etc) either manually directly on the Plug, locally from panel or control device and/or remotely via mobile application.

## FEATURES

- FW2 GFSK protocol.
- Frequency Band: 868.35MHz / 916MHz.
- Supervision transmission.
- Color LED indications
- Range up to 150m on open space.

## OVERVIEW

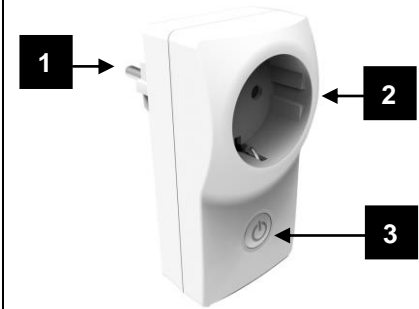

1	Connection to AC Mains (IN)
2	Power Socket OUT (Maximum 3200W)
3	LED Status Indicator (RED during ON status)

## LEARNING PROCEDURE

The learning procedure of the FW2-SPLG is very simple and easy.

1. If inserted, remove the FW2-APC from the mains.
2. Initiate the Control Panel in "Radio Output" learning process.
3. Select the output number from Output #6 to Output #16 and start the learning procedure on control panel.
4. Plug the FW2-SPLG to the mains.
5. The RED Led is blinking 3 times and switch off.
6. The learning procedure is done. The module can now be controlled as Output from your panel.

## INSTALLATION

The FW2-SPLG Plug is very easy to install and suits to major mains sockets. *(please refer to your installer for specific models)*

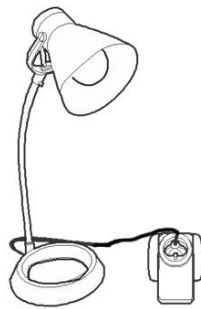

## TRANSMISSION TESTS

After learning and installing the socket we recommend to perform transmission tests.

Changing the ON/OFF switch state by activating and deactivating the related Output.

- Output ON switch ON the socket module
- Output OFF switch OFF the socket module



LED ON	LED OFF
<ul style="list-style-type: none"> <li>• The RED Led is ON</li> <li>• Socket activated</li> <li>• Appliance powered</li> </ul>	<ul style="list-style-type: none"> <li>• The RED Led is OFF</li> <li>• Socket not activated</li> <li>• Appliance not powered</li> </ul>

## MANUAL CONTROL

The FW2-SPLG can be manually controlled directly from the module.

1. Follow the "Learning Procedure" part.
2. Press 2 times the ON/OFF button for 1 sec to initiate the unit – Red Led should be switched on.
3. Press the ON/OFF button for 1 second to switch off the unit.
4. Connect your appliance (lamp for example)

## REGULATORY APPROVALS

The FW2-SPLG Complies with the R&TTE 1999/5/CE directive and applicable standards:

EN60669-1:1999+A1:2002+A2:2008

EN60669-2-1:2004

EN301489-1 V1.9.2

EN301489-3 V1.4.1

EN300220-2 V2.4.1



## TECHNICAL SPECIFICATIONS

Operation Method	Relay Switch OPEN / CLOSE
Data Protocol	FreeWave2 ISM
Frequency	868-869MHz / 916-917MHz
Identification	Unique ID serial number – 24 bit
Events Transmission	ON/OFF Status, Supervision
Supervision Time	7 min by default (configurable between 1 to 30 minutes)
Range in open space	150m
Power Supply	Powered directly from the mains
Current Consumptions	Standby ~4mA@220VAC Receive mode ~24 mA Transmit mode ~45 mA
Operating Temp	-10°C to +55°C
Dimensions	100mm x 50mm x 75mm
Weight	100 gr.

## CROW ELECTRONIC ENGINEERING LTD. ("Crow") - WARRANTY POLICY CERTIFICATE

This Warranty Certificate is given in favor of the purchaser (hereunder the "Purchaser") purchasing the products directly from Crow or from its authorized distributor.

Crow warrants these products to be free from defects in materials and workmanship under normal use and service for a period of 24 months from the last day of the week and year whose numbers are printed on the printed circuit board inside these products (hereunder the "Warranty Period").

Subject to the provisions of this Warranty Certificate, during the Warranty Period, Crow undertakes, at its sole discretion and subject to Crow's procedures, as such procedures are from time to time, to repair or replace, free of charge for materials and/or labor, products proved to be defective in materials or workmanship under normal use and service. Repaired products shall be warranted for the remainder of the original Warranty Period.

All transportation costs and in-transit risk of loss or damage related, directly or indirectly, to products returned to Crow for repair or replacement shall be borne solely by the Purchaser.

Crow's warranty under this Warranty Certificate does not cover products that is defective (or shall become defective) due to: (a) alteration of the products (or any part thereof) by anyone other than Crow; (b) accident, abuse, negligence, or improper maintenance; (c) failure caused by a product which Crow did not provide; (d) failure caused by software or hardware which Crow did not provide; (e) use or storage other than in accordance with Crow's specified operating and storage instructions. There are no warranties, expressed or implied, of merchantability or fitness of the products for a particular purpose or otherwise, which extend beyond the description on the face hereof.

This limited Warranty Certificate is the Purchaser's sole and exclusive remedy against Crow and Crow's sole and exclusive liability toward the Purchaser in connection with the products, including without limitation - for defects or malfunctions of the products. This Warranty Certificate replaces all other warranties and liabilities, whether oral, written, (non-mandatory) statutory, contractual, in tort or otherwise.

In no case shall Crow be liable to anyone for any consequential or incidental damages (inclusive of loss of profit, and whether occasioned by negligence of the Crow or any third party on its behalf) for breach of this or any other warranty, expressed or implied, or upon any other basis of liability whatsoever. Crow does not represent that these products can not be compromised or circumvented; that these products will prevent any person injury or property loss or damage by burglary, robbery, fire or otherwise; or that these products will in all cases provide adequate warning or protection.

Purchaser understands that a properly installed and maintained product may in some cases reduce the risk of burglary, fire, robbery or other events occurring without providing an alarm, but it is not insurance or a guarantee that such will not occur or that there will be no personal injury or property loss or damage as a result.

Consequently, Crow shall have no liability for any personal injury; property damage or any other loss based on claim that these products failed to give any warning.

If Crow is held liable, whether directly or indirectly, for any loss or damage with regards to these products, regardless of cause or origin, Crow's maximum liability shall not in any case exceed the purchase price of these products, which shall be the complete and exclusive remedy against Crow



12 Kineret Street.  
Airport City, 70100 Israel

Tel. +972 3 9726000  
Fax. +972 3 9726001

sales@crow.co.il  
support@crow.co.il

[www.thecrowgroup.com](http://www.thecrowgroup.com)

These instructions supersede all previous issues in circulation prior to August 2016